

Installation Fittings

PVC TEES SCH 80 - Fitting only

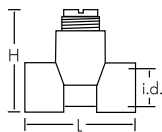

Part No.	Code	Size	L	H	i.d	Sensor Type
PV8T005F	159 000 527	0.50 in.	3.75	3.6	0.85	Flow -X0, pH -XX
PV8T007F	159 000 529	0.75 in.	3.75	3.8	1.06	Flow -X0, pH -XX
PV8T010F	159 000 531	1.00 in.	4.26	4.0	1.33	Flow -X0, pH -XX
PV8T012F	159 000 533	1.25 in.	4.36	4.4	1.67	Flow -X0, pH -XX
PV8T015F	159 000 535	1.50 in.	4.90	4.6	1.91	Flow -X0, pH -XX

• For use with P51530-X0, 3-2536-X0, 3-8510-X0, 3-8512-X0, 3-2537-XC-X0, 3-2551-X0-X0-XX, 3-272X-XX

PVC TEES SCH 80 - with Pipe¹

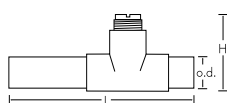

Part No.	Code	Size	L	H	o.d.	Sensor Type
PV8T005	159 000 526	0.50 in.	14	3.6	0.84	Flow -X0, pH -XX
PV8T007	159 000 528	0.75 in.	14	3.8	1.05	Flow -X0, pH -XX
PV8T010	159 000 530	1.00 in.	17	4.0	1.32	Flow -X0, pH -XX
PV8T012	159 000 532	1.25 in.	20	4.4	1.66	Flow -X0, pH -XX
PV8T015	159 000 534	1.50 in.	24	4.6	1.90	Flow -X0, pH -XX
PV8T020	198 801 415	2.00 in.	24	5.0	2.38	Flow -X0, pH -XX
PV8T025	198 801 573	2.50 in.	24	5.4	2.88	Flow -X0, pH -XX
PV8T030	198 801 416	3.00 in.	24	6.0	3.50	Flow -X0, pH -XX
PV8T040	198 801 436	4.00 in.	24	7.0	4.50	Flow -X0, pH -XX

• For use with P51530-X0, 3-2536-X0, 3-8510-X0, 3-8512-X0, 3-2537-XC-X0, 3-2551-X0-X0-XX, 3-272X-XX

PVC Clamp-on Saddles SCH 80

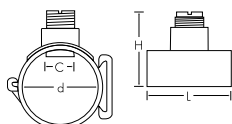

Part No.	Code	Size	L	H	d	C	Sensor Type
PV8S020	159 000 637	2.00 in.	4.00	5.0	2.375	1.43	Flow -X0, pH -XX
PV8S025	159 000 638	2.50 in.	4.75	5.4	2.875	1.43	Flow -X0, pH -XX
PV8S030	198 150 577	3.00 in.	5.00	6.0	3.500	1.43	Flow -X0, pH -XX
PV8S040	198 150 578	4.00 in.	5.00	7.0	4.500	1.43	Flow -X1
PV8S060	198 150 579	6.00 in.	5.00	10.0	6.625	2.25	Flow -X1
PV8S080	159 000 639	8.00 in.	5.00	11.5	8.625	2.25	Flow -X1

• For use with P51530-X0/-X1, 3-2536-X0/-X1, 3-8510-X0/-X1, 3-8512-X0/-X1, 3-2537-XC-X0/-X1, 3-2551-X0-XX/-X1-XX, 3-272X-XX

- Mounts on PVC pipe
- C - Clearance dimension
- EPR (EPDM) O-ring

CPVC Tees SCH 80 - Fitting only

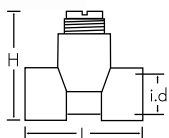

Part No.	Code	Size	L	H	i.d	Sensor Type
CPV8T005F	159 000 409	0.50 in.	3.75	3.6	0.85	Flow -X0, pH -XX
CPV8T007F	159 000 411	0.75 in.	3.75	3.8	1.06	Flow -X0, pH -XX
CPV8T010F	159 000 413	1.00 in.	4.26	4.0	1.33	Flow -X0, pH -XX
CPV8T012F	159 000 415	1.25 in.	4.36	4.4	1.67	Flow -X0, pH -XX
CPV8T015F	159 000 417	1.50 in.	4.90	4.6	1.91	Flow -X0, pH -XX

• For use with P51530-X0, 3-2536-X0, 3-8510-X0, 3-8512-X0, 3-2537-XC-X0, 3-2551-X0-X0-XX, 3-272X-XX

CPVC Tees SCH 80 - with Pipe¹

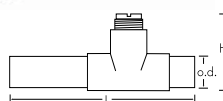

Part No.	Code	Size	L	H	o.d	Sensor Type
CPV8T005	159 000 408	0.50 in.	14	3.6	0.84	Flow -X0, pH -XX
CPV8T007	159 000 410	0.75 in.	14	3.8	1.05	Flow -X0, pH -XX
CPV8T010	159 000 412	1.00 in.	17	4.0	1.32	Flow -X0, pH -XX
CPV8T012	159 000 414	1.25 in.	20	4.4	1.66	Flow -X0, pH -XX
CPV8T015	159 000 416	1.50 in.	24	4.6	1.90	Flow -X0, pH -XX

• For use with P51530-X0, 3-2536-X0, 3-8510-X0, 3-8512-X0, 3-2537-XC-X0, 3-2551-X0-X0-XX, 3-272X-XX

¹Pipe lengths included with these fittings do not satisfy straight-run requirements for all installation configurations.

Installation Fittings

Metric PP Wafer Fittings (EPR/EPDM gaskets)

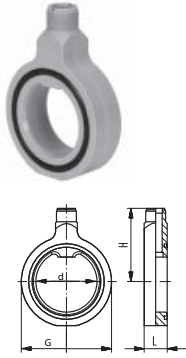

Part No.	Code	DN	G	H	d	Sensor Type
PPMTE025	727 311 012	65 mm	122	133	75	Flow -X1
PPMTE030	727 311 013	80 mm	138	140	90	Flow -X1
PPMTE040	727 311 014	100 mm	158	149	110	Flow -X1
PPMTE050	727 311 016	125 mm	188	149	140	Flow -X1
PPMTE060	727 311 017	150 mm	212	156	160	Flow -X1
PPMTE080	727 311 020	200 mm	268	178	225	Flow -X1
PPMTE100	727 311 022	250 mm	320	273	280	Flow -X2
PPMTE120	727 311 023	300 mm	370	285	315	Flow -X2

- For use with P51530-X1/-X2, 3-2536-X1/-X2, 3-8510-X1, 3-8512-X1, 3-2537-XC-X1, 3-2551-X1-XX/X2-XX
- "L" dimension for all wafers is 48 mm

Metric PP Wafer fittings (FPM gaskets)

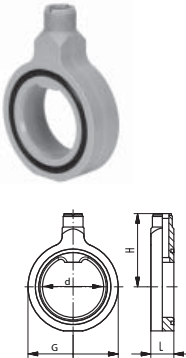

Part No.	Code	DN	G	H	d	Sensor Type
PPMTF025	727 311 042	65 mm	122	133	75	Flow -X1
PPMTF030	727 311 043	80 mm	138	140	90	Flow -X1
PPMTF040	727 311 044	100 mm	158	149	110	Flow -X1
PPMTF050	727 311 046	125 mm	188	149	140	Flow -X1
PPMTF060	727 311 047	150 mm	212	156	160	Flow -X1
PPMTF080	727 311 050	200 mm	268	178	225	Flow -X1
PPMTF100	727 311 052	250 mm	320	273	280	Flow -X2
PPMTF120	727 311 053	300 mm	370	285	315	Flow -X2

- For use with P51530-X1/-X2, 3-2536-X1/-X2, 3-8510-X1, 3-8512-X1, 3-2537-XC-X1, 3-2551-X1-XX/X2-XX
- "L" dimension for all wafers is 48 mm

Metric PVDF Wafer Fitting (FPM gaskets)

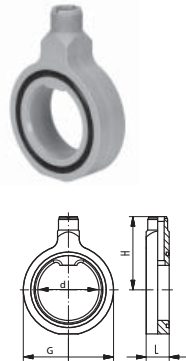

Part No.	Code	DN	G	H	d	Sensor Type
SFMTF025	735 311 042	65 mm	122	135	75	Flow -X1
SFMTF030	735 311 043	80 mm	138	141	90	Flow -X1
SFMTF040	735 311 044	100 mm	158	152	110	Flow -X1
SFMTF050	735 311 046	125 mm	188	153	140	Flow -X1
SFMTF060	735 311 047	150 mm	212	161	160	Flow -X1
SFMTF080	735 311 050	200 mm	268	185	225	Flow -X1

- For use with P51530-X1, 3-2536-X1, 3-8510-X1, 3-8512-X1, 3-2537-XC-X1, 3-2551-X1-XX
- "L" dimension for all wafers is 48 mm

Installation Fittings

BSP PVC-U Tee Fittings

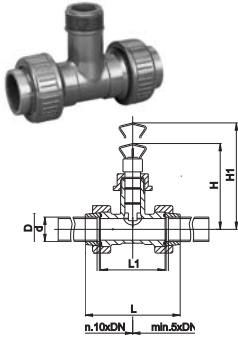

Part No.	Code	Size	H	H1	L	L1	d	Sensor Type
PVAT005	721 310 336	0.50 in.	145	225	131	90	20	Flow -X0, pH -XX
PVAT007	721 310 337	0.75 in.	148	228	147	100	25	Flow -X0, pH -XX
PVAT010	721 310 338	1.00 in.	151	231	164	110	32	Flow -X0, pH -XX
PVAT012	721 310 339	1.25 in.	155	235	171	110	40	Flow -X0, pH -XX
PVAT015	721 310 340	1.50 in.	159	239	188	120	50	Flow -X0, pH -XX
PVAT020	721 310 341	2.00 in.	164	244	212	130	63	Flow -X0, pH -XX

- For use with P51530-X0, 3-2536-X0, 3-8510-X0, 3-8512-X0, 3-2537-XC-X0, 3-2551-X0-XX, 3-272X-XX
- FPM O-ring
- These fittings are only available from your local Georg Fischer sales office

BSP PVC-U Saddle Fittings

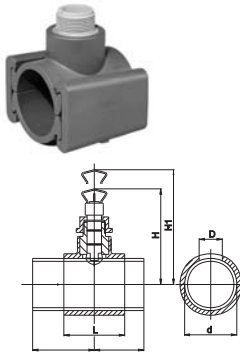

Part No.	Code	Size	D	H	H1	L	d	Sensor Type
PVAS030	198 150 550	3.0 in.	39	175	225	105	90	Flow -X0, pH -XX
PVAS040	198 150 551	4.0 in.	39	184	264	105	110	Flow -X0, pH -XX
PVAS060	198 150 554	6.0 in.	39	224	339	120	160	Flow -X1

- For use with P51530-X0/-X1, 3-2536-X0/-X1, 3-8510-X0/-X1, 3-8512-X0/-X1, 3-2537-XC-X0/-X1, 3-2551-X0-XX/-X1-XX, 3-272X-XX
- EPR (EPDM) Gasket
- These fittings are only available from your local Georg Fischer sales office

PP Clamp-On Saddle Fittings

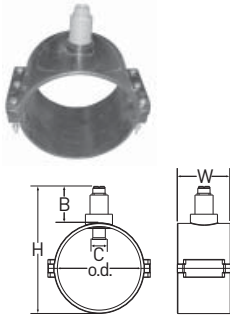

Part No.	Code	Size	L	H	o.d.	C	Sensor Type
PPS100	159 000 693	10 in.	7.04	16.75	10.75	2.25	Flow -X2
PPS120	159 000 694	12 in.	9.68	18.18	12.75	2.25	Flow -X2

- For use with P51530-X2, 3-2536-X2, 3-2551-X2-XX
- Buna-N O-ring

PVC Glue-On Saddle Fittings SCH 80

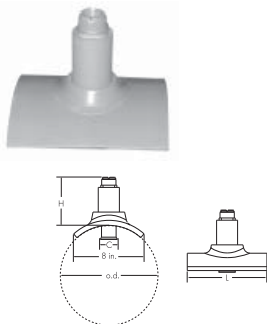

Part No.	Code	Size	W	H	o.d.	C	Sensor Type
PV8S100	159 000 695	10 in.	9.0	5.43	10.75	2.25	Flow -X2
PV8S120	159 000 696	12 in.	9.0	5.15	12.75	2.25	Flow -X2

- For use with P51530-X2, 3-2536-X2, 3-2551-X2-XX

PP Clamp-on Saddle Fittings

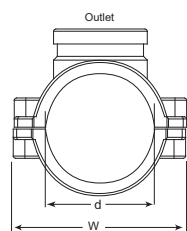

Mfr. Part No.	Code	Size Range	Outlet	d	W	L	H
2007-0225	159 000 812	2.50 in.	1.50 in.	2.875	4.84	3.11	4.29
2007-0230	159 000 813	3.00 in.	1.50 in.	3.50	5.43	3.43	4.84
2007-0240	159 000 814	4.00 in.	1.50 in.	4.50	5.98	3.90	5.90
2007-0260	159 000 815	6.00 in.	2.00 in.	6.625	8.90	4.49	8.46
2007-0280	159 000 816	8.00 in.	2.00 in.	8.625	11.3	5.71	11.3
2007-0210	159 000 817	10.00 in.	2.00 in.	10.75	12.5	7.04	13.25
2007-0212	159 000 818	12.00 in.	2.00 in.	12.75	16.0	9.68	14.00

- For use with 3-2540-XX, 3-2552-3X, 3-3719-11/-21 Wet-Tap assembly with the 3-275X-WTX Wet-Tap Electrode

Installation Fittings

Metric PVC-U Saddle Fittings

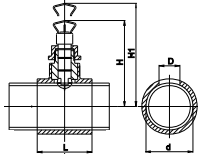

Part No.	Code	DN	D	H	H1	L	d	Sensor Type
PVMS025	198 150 538	65 mm	30	170	250	105	75	Flow -X0, pH -XX
PVMS030	198 150 539	80 mm	39	175	255	105	90	Flow -X0, pH -XX
PVMS040	198 150 540	100 mm	39	184	264	105	110	Flow -X0, pH -XX
PVMS060	198 150 543	150 mm	39	224	339	120	160	Flow -X1
PVMS080	198 150 545	200 mm	39	251	366	120	225	Flow -X1

- For use with P51530-X0/-X1, 3-2536-X0/-X1, 3-8510-X0/-X1, 3-8512-X0/-X1, 3-2537-XC-X0/-X1, 3-2551-X0-XX/-X1-XX, 3-272X-XX
- EPR (EPDM) Gasket
- These fittings are only available from your local Georg Fischer sales office

Metric PVC-U Tee Fittings

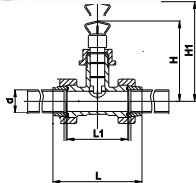

Part No.	Code	DN	H	H1	L	L1	d	Sensor Type
PVMT005	721 310 036	15 mm	145	225	128	90	20	Flow -X0, pH -XX
PVMT007	721 310 037	20 mm	148	228	144	100	25	Flow -X0, pH -XX
PVMT010	721 310 038	25 mm	151	231	160	110	32	Flow -X0, pH -XX
PVMT012	721 310 039	32 mm	155	235	168	110	40	Flow -X0, pH -XX
PVMT015	721 310 040	40 mm	159	239	188	120	50	Flow -X0, pH -XX
PVMT020	721 310 041	50 mm	164	244	212	130	63	Flow -X0, pH -XX

- For use with P51530-X0, 3-2536-X0, 3-8510-X0, 3-8512-X0, 3-2537-XC-X0, 3-2551-X0-XX, 3-272X-XX
- FPM O-ring
- These fittings are only available from your local Georg Fischer sales office
- EPR (EPDM) O-ring now available by special order

Metric PP Union Tee Fittings

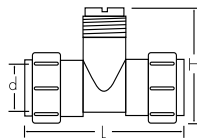

Part No.	Code	DN	L	H	d	Sensor Type
PPMT005	727 310 036	15 mm	128	97	20	Flow -X0, pH -XX
PPMT007	727 310 037	20 mm	142	105	25	Flow -X0, pH -XX
PPMT010	727 310 038	25 mm	156	110	32	Flow -X0, pH -XX
PPMT012	727 310 039	32 mm	160	120	40	Flow -X0, pH -XX
PPMT015	727 310 040	40 mm	176	130	50	Flow -X0, pH -XX
PPMT020	727 310 041	50 mm	194	146	63	Flow -X0, pH -XX

- For use with P51530-X0, 3-2536-X0, 3-8510-X0, 3-8512-X0, 3-2537-XC-X0, 3-2551-X0-XX, 3-272X-XX
- Socket fusion equipment is required to install PP union tees.
- FPM O-rings

Metric PVDF Union Tee Fittings

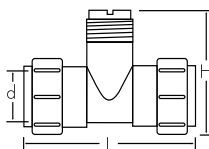

Part No.	Code	DN	L	H	d	Sensor Type
SFMT005	735 310 036	15 mm	128	97	20	Flow -X0, pH -XX
SFMT007	735 310 037	20 mm	142	105	25	Flow -X0, pH -XX
SFMT010	735 310 038	25 mm	156	110	32	Flow -X0, pH -XX
SFMT012	735 310 039	32 mm	160	120	40	Flow -X0, pH -XX
SFMT015	735 310 040	40 mm	176	130	50	Flow -X0, pH -XX
SFMT020	735 310 041	50 mm	194	146	63	Flow -X0, pH -XX

- For use with P51530-X0, 3-2536-X0, 3-8510-X0, 3-8512-X0, 3-2537-XC-X0, 3-2551-X0-XX, 3-272X-XX
- Socket fusion equipment is required to install PVDF union tees.
- FPM O-rings

Installation Fittings

Carbon Steel Threaded Tees with NPT Threads

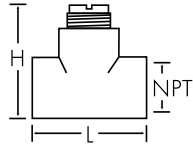

Part No.	Code	Size	L	H	Sensor Type
CS4T005	198 801 459	0.50 in.	3.6	4.0	Flow -X0, pH -XX
CS4T007	198 801 460	0.75 in.	3.6	4.2	Flow -X0, pH -XX
CS4T010	198 801 461	1.00 in.	3.6	4.2	Flow -X0, pH -XX
CS4T012	198 801 462	1.25 in.	3.8	4.5	Flow -X0, pH -XX
CS4T015	198 801 419	1.50 in.	4.1	4.8	Flow -X0, pH -XX
CS4T020	198 801 463	2.00 in.	4.9	5.3	Flow -X0, pH -XX

- For use with P51530-X0, 3-2536-X0, 3-8510-X0, 3-8512-X0, 3-2537-XC-X0, 3-2551-X0-XX, 3-272X-XX
- PVDF insert - all sizes
- For use with SCH 40 metal pipe (ASTM)
- PTFE wetted material. Contact factory for available options.

Copper Sweat-on Tee with PVDF insert

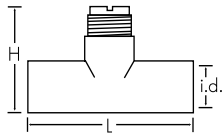

Part No.	Code	Size	L	H	i.d.	Sensor Type
CUKT005	198 801 687	0.50 in.	3.15	3.57	0.62	Flow -X0, pH -XX
CUKT007	198 801 688	0.75 in.	2.96	3.52	0.87	Flow -X0, pH -XX
CUKT010	198 801 689	1.00 in.	3.23	3.80	1.12	Flow -X0, pH -XX
CUKT012	198 801 690	1.25 in.	4.16	4.12	1.38	Flow -X0, pH -XX
CUKT015	198 801 691	1.50 in.	4.43	4.34	1.63	Flow -X0, pH -XX
CUKT020	198 801 418	2.00 in.	5.31	4.86	2.11	Flow -X0, pH -XX

- For use with P51530-X0, 3-2536-X0, 3-8510-X0, 3-8512-X0, 3-2537-XC-X0, 3-2551-X0-XX, 3-272X-XX
- No insert up to 1 in., over 1 in. - PVDF insert
- For use with copper pipe (SCH K)
- PTFE wetted material. Contact factory for available options.

Galvanized Iron Threaded Tee with NPT Threads and PVDF insert

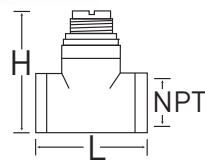

Part No.	Code	Size	NPT	L	H	Sensor Type
IR4T010	198 801 421	1.00 in.	1.00	3.4	4.1	Flow -X0, pH -XX
IR4T012	198 801 422	1.25 in.	1.25	3.56	4.34	Flow -X0, pH -XX
IR4T015	198 801 423	1.50 in.	1.50	3.75	4.67	Flow -X0, pH -XX
IR4T020	198 801 424	2.00 in.	2.00	3.90	5.05	Flow -X0, pH -XX

- For use with P51530-X0, 3-2536-X0, 3-8510-X0, 3-8512-X0, 3-2537-XC-X0, 3-2551-X0-XX, 3-272X-XX
- PVDF insert - all sizes
- For use with SCH 40 metal pipe (ASTM)
- PTFE wetted material. Contact factory for available options.

316 SS (1.4401) Threaded Tees with NPT Threads with PVDF insert

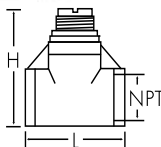

Part No.	Code	Size	L	H	Sensor Type
CR4T005	198 801 554	0.50 in.	3.6	4.0	Flow -X0, pH -XX
CR4T007	198 801 555	0.75 in.	3.6	4.2	Flow -X0, pH -XX
CR4T010	198 801 556	1.00 in.	3.6	4.2	Flow -X0, pH -XX
CR4T012	198 801 783	1.25 in.	3.8	4.5	Flow -X0, pH -XX
CR4T015	198 801 784	1.50 in.	4.1	4.8	Flow -X0, pH -XX
CR4T020	198 801 785	2.00 in.	4.9	5.3	Flow -X0, pH -XX

- For use with P51530-X0, 3-2536-X0, 3-8510-X0, 3-8512-X0, 3-2537-XC-X0, 3-2551-X0-XX, 3-272X-XX
- PVDF insert - all sizes
- For use with SCH 40 metal pipe (ASTM)
- PTFE wetted material. Contact factory for available options.

Brass Threaded Tee with NPT Threads and PVDF insert



Part No.	Code	Size	NPT	L	H	Sensor Type
BR4T010	198 801 770	1.00 in.	1.00	3.36	4.09	Flow -X0, pH -XX
BR4T012	198 801 771	1.25 in.	1.25	3.42	4.42	Flow -X0, pH -XX
BR4T015	198 801 772	1.50 in.	1.50	3.46	4.70	Flow -X0, pH -XX
BR4T020	198 801 773	2.00 in.	2.00	3.68	5.19	Flow -X0, pH -XX

- For use with P51530-X0, 3-2536-X0, 3-8510-X0, 3-8512-X0, 3-2537-XC-X0, 3-2551-X0-XX, 3-272X-XX
- PVDF insert - all sizes
- For use with SCH 40 metal pipe (ASTM)
- PTFE wetted material. Contact factory for available options.

Installation Fittings

Carbon Steel Weld-on Weldolets for use with SCH 40 metal pipe (ASTM)

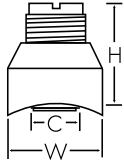

Part No.	Code	Size	W	H	C	Sensor Type
CS4W025	198 801 464	2.50 in.	2.60	2.50	1.44	Flow -X0, pH -XX
CS4W030	198 801 557	3.00 in.	2.60	2.50	1.44	Flow -X0, pH -XX
CS4W040	198 801 552	4.00 in.	2.60	2.50	1.44	Flow -X0, pH -XX
CS4W050	198 801 465	5.00 in.	3.50	3.00	2.25	Flow -X1
CS4W060	198 801 553	6.00 in.	3.50	3.00	2.25	Flow -X1
CS4W080	198 801 574	8.00 in.	3.50	3.00	2.25	Flow -X1
CS4W100	198 801 575	10.0 in.	3.50	5.75	2.25	Flow -X2
CS4W120	198 801 576	12.0 in.	3.50	5.40	2.25	Flow -X2

- For use with P51530-X0/-X1/-X2, 3-2536-X0/-X1/-X2, 3-8510-X0/-X1, 3-8512-X0/-X1, 3-2537-XC-X0/-X1, 3-2551-X0-XX/-X1-XX/-X2-XX, 3-272X-XX
- C - Clearance dimension
- Up to 8 in. - PVDF insert, over 8 in. - PVC insert
- PTFE wetted material. Contact factory for available options.

Brass Brazolet with PVDF insert for use with copper pipe (SCH 40 ASTM)

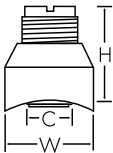

Part No.	Code	Size	W	H	C	Sensor Type
BR4B025	198 801 794	2.5 in.	2.50	2.50	1.44	Flow -X0, pH -XX
BR4B030	198 801 795	3.0 in.	2.50	2.50	1.44	Flow -X0, pH -XX
BR4B040	198 801 796	4.0 in.	2.50	2.50	1.44	Flow -X0, pH -XX
BR4B050	198 801 797	5.0 in.	3.50	3.40	2.25	Flow -X1
BR4B060	198 801 798	6.0 in.	3.50	3.20	2.25	Flow -X1
BR4B080	198 801 799	8.0 in.	3.50	3.00	2.25	Flow -X1
BR4B100	198 801 800	10.0 in.	3.50	5.75	2.25	Flow -X2
BR4B120	198 801 801	12.0 in.	3.50	5.40	2.25	Flow -X2

- For use with P51530-X0/-X1/-X2, 3-2536-X0/-X1/-X2, 3-8510-X0/-X1, 3-8512-X0/-X1, 3-2537-XC-X0/-X1, 3-2551-X0-XX/-X1-XX/-X2-XX, 3-272X-XX
- C - Clearance dimension
- Up to 8 in. - PVDF insert, over 8 in. - PVC insert
- PTFE wetted material. Contact factory for available options.

316 SS (1.4401) Weldolets with PVDF insert for use with SCH 40 metal pipe (ASTM)

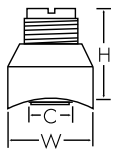

Part No.	Code	Size	W	H	C	Sensor Type
CR4W025	198 801 786	2.5 in.	2.50	2.45	1.44	Flow -X0, pH -XX
CR4W030	198 801 787	3.0 in.	2.50	2.50	1.44	Flow -X0, pH -XX
CR4W040	198 801 788	4.0 in.	2.50	3.25	1.44	Flow -X0, pH -XX
CR4W050	198 801 789	5.0 in.	3.50	3.50	2.25	Flow -X1
CR4W060	198 801 790	6.0 in.	3.50	3.50	2.25	Flow -X1
CR4W080	198 801 791	8.0 in.	3.50	3.00	2.25	Flow -X1
CR4W100	198 801 792	10.0 in.	3.50	5.50	2.25	Flow -X2
CR4W120	198 801 793	12.0 in.	3.50	5.40	2.25	Flow -X2

- For use with P51530-X0/-X1/-X2, 3-2536-X0/-X1/-X2, 3-8510-X0/-X1, 3-8512-X0/-X1, 3-2537-XC-X0/-X1, 3-2551-X0-XX/-X1-XX/-X2-XX, 3-272X-XX
- Up to 8 in. - PVDF insert, over 8 in. - PVC insert
- C - Clearance dimension
- PTFE wetted material. Contact factory for available options.

Iron Strap-on Saddle for use with SCH 80 metal pipe (ASTM)

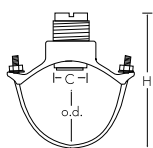

Part No.	Code	Size	H	o.d min	o.d max	C	Sensor Type
IR8S020	198 801 425	2.0 in.	5.5	2.35	2.56	1.44	Flow -X0, pH -XX
IR8S025	198 801 426	2.5 in.	5.5	2.44	2.91	1.44	Flow -X0, pH -XX
IR8S030	198 801 427	3.0 in.	6.5	2.97	3.54	1.44	Flow -X0, pH -XX
IR8S040	198 801 420	4.0 in.	7.5	3.74	4.55	2.25	Flow -X0, pH -XX
IR8S050	198 801 429	5.0 in.	9.0	4.74	5.63	2.25	Flow -X1
IR8S060	198 801 430	6.0 in.	10.5	5.94	6.70	2.25	Flow -X1
IR8S080	198 801 431	8.0 in.	12.0	7.69	8.72	2.25	Flow -X1
IR8S100	198 801 432	10.0 in.	18.0	10.64	12.12	2.25	Flow -X2
IR8S120	198 801 433	12.0 in.	20.0	12.62	14.32	2.25	Flow -X2

- For use with P51530-X0/-X1/-X2, 3-2536-X0/-X1/-X2, 3-8510-X0/-X1, 3-8512-X0/-X1, 3-2537-XC-X0/-X1, 3-2551-X0-XX/-X1-XX/-X2-XX, 3-272X-XX
- C - Clearance dimension
- Up to 8 in. - PVDF insert, over 8 in. - PVC insert
- Buna-N O-ring
- Larger sizes may be available and PTFE wetted material. Contact factory.

Installation Fittings

Fibreglass Glue-on Tees

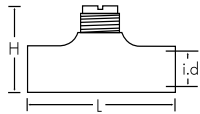

Part No.	Code	Size	L	H	i.d.	Sensor Type
FPT015	159 000 446	1.50 in.	5.5	4.7	1.92	Flow -X0, pH -XX
FPT020	159 000 447	2.00 in.	7.7	8.0	2.38	Flow -X0, pH -XX

- For use with P51530-X0, 3-2536-X0, 3-8510-X0, 3-8512-X0, 3-2537-XC-X0, 3-2551-X0-XX, 3-272X-XX
- PVDF insert - all sizes
- PTFE wetted material. Contact factory for available options.

Fibreglass Glue-on Saddles

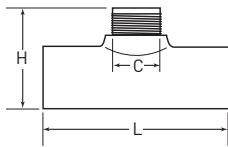

Part No.	Code	Size	L	H	o.d.	C	Sensor Type
FPS030	159 000 441	3.00 in.	5.9	4.5	3.50	1.44	Flow -X0, pH -XX
FPS040	159 000 442	4.00 in.	8.0	4.5	4.50	1.44	Flow -X0, pH -XX
FPS060	159 000 443	6.00 in.	8.0	6.5	6.62	2.25	Flow -X1
FPS080	198 801 417	8.00 in.	10.0	8.0	8.62	2.25	Flow -X1
FPS100	159 000 444	10.0 in.	12.0	8.5	10.75	2.25	Flow -X2
FPS120	159 000 445	12.0 in.	12.0	8.5	12.75	2.25	Flow -X2

- For use with P51530-X0/-X1/-X2, 3-2536-X0/-X1/-X2, 3-8510-X0/-X1, 3-8512-X0/-X1, 3-2537-XC-X0/-X1, 3-2551-X0-XX/-X1-XX/-X2-XX, 3-272X-XX
- C - Clearance dimension
- Up to 8 in. - PVDF insert, over 8 in. - PVC
- Mounts on fibreglass pipe
- PTFE wetted material. Contact factory for available options.
- Custom sizes available

JIS PVC-U Tee Fittings

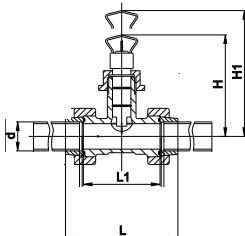

EPR (EPDM)	FPM	DN	H	H1	L	L1	d	Sensor Type
200 072 063	200 070 933	15 mm	145	225	468	90	22	Flow -X0, pH -XX
200 072 064	200 070 934	20 mm	148	228	144	100	26	Flow -X0, pH -XX
200 072 065	200 070 935	25 mm	151	231	160	110	32	Flow -X0, pH -XX
200 072 066	200 070 936	32 mm	155	235	168	110	38	Flow -X0, pH -XX
200 072 067	200 070 937	40 mm	159	239	188	120	48	Flow -X0, pH -XX
200 072 068	200 070 902	50 mm	164	244	212	130	60	Flow -X0, pH -XX

- For use with P51530-X0, 3-2536-X0, 3-8510-X0, 3-8512-X0, 3-2537-XC-X0, 3-2551-X0-XX, 3-272X-XX
- Choice FPM or EPR (EPDM) O-ring
- These fittings are only available from the Georg Fischer sales office in Japan.
- Appearance varies in DN15 mm

JIS PVC-U Tee Fittings (Flange Type)

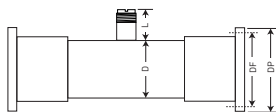

Code	DN	D	DF	DP	L	Sensor Type
200 070 892	65 mm	76	175	140	57.2	Flow -X0, pH -XX
200 070 893	80 mm	89	185	150	56.8	Flow -X0, pH -XX
200 070 894	100 mm	114	210	175	56.9	Flow -X0, pH -XX
200 070 895	125 mm	140	250	210	82.0	Flow -X1
200 070 896	150 mm	165	280	240	77.8	Flow -X1
200 070 897	200 mm	216	330	290	71.6	Flow -X1

- For use with P51530-X0/-X1, 3-2536-X0/-X1, 3-8510-X0/-X1, 3-8512-X0/-X1, 3-2537-XC-X0/-X1, 3-2551-X0-XX/-X1-XX, 3-272X-XX
- These fittings are only available from the Georg Fischer sales office in Japan.

Installation Fittings

Metalex Socket Weld Mini-Tap (1.4401)

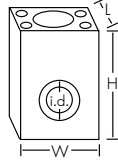

Part No.	Code	Size	L	W	H	i.d.
P526-2005	198 840 501	0.50 in.	2.0	2.4	3.0	0.850
P526-2007	198 840 502	0.75 in.	2.0	2.4	3.0	1.060
P526-2010	198 840 503	1.00 in.	2.0	2.4	3.0	1.325

- For use with P525-1 and P525-1S only
- For use with SS pipe

Metalex Weld-On Mini-Tap (1.4401)



Part No.	Code	Size	W	H	C
P526-2012	159 000 494	1.25 in.	1.66	2.25	1.062
P526-2015	198 840 506	1.50 in.	1.66	2.20	1.062
P526-2020	159 000 495	2.00 in.	1.66	2.17	1.062
P526-2025	159 000 496	2.50 in.	1.66	2.10	1.062
P526-2030	159 000 497	3.00 in.	1.66	2.00	1.062
P526-2040	159 000 498	4.00 in.	1.66	1.95	1.062
P526-2050	159 000 499	5.00 in.	1.66	1.83	1.062
P526-2060	159 000 500	6.00 in.	1.66	1.75	1.062
P526-2080	159 000 501	8.00 in.	1.66	1.56	1.062
P526-2100	159 000 502	10.0 in.	1.66	1.35	1.062
P526-2120	159 000 503	12.0 in.	1.66	1.15	1.062

- For use with P525-2 and P525-2S only
- For use with SS pipe
- Gasket Klinger C4401 Thermoseal

Metalex Strap-On Saddle (1.4401)

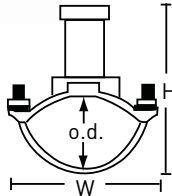

Part No.	Code	Size	W	H	o.d min.	o.d max.
P526-1020	159 000 484	2.00 in.	5.5	7.0	2.35	2.56
P526-1025	159 000 485	2.50 in.	5.5	7.0	2.44	2.91
P526-1030	159 000 486	3.00 in.	6.0	7.5	2.97	3.54
P526-1040	159 000 487	4.00 in.	7.0	8.0	3.74	4.55
P526-1050	159 000 488	5.00 in.	8.0	10.0	4.74	5.63
P526-1060	159 000 489	6.00 in.	9.5	10.5	5.94	6.70
P526-1080	159 000 490	8.00 in.	12.0	12.75	7.69	8.72
P526-1100	159 000 491	10.00 in.	15.0	14.5	10.64	12.12
P526-1120	159 000 492	12.00 in.	17.0	17.0	12.62	14.32

- For use with P525-3 and P525-3S only
- Buna-N O-ring

Installation Fittings

Iron Multi/Saddle Plus 201



Code	Inch	PN Water	Sensor Type
709 613 736	1.25 in.	16.0	2552-1 or 2552-2
709 613 738	1.50 in.	16.0	2552-3, 2540-XX, 3719-11

- For use with 3-2552-1X/-2X/-3X, 3-2540-XX, 3-3719-11 Wet-Tap assembly with the 3-275X-WTX Wet-Tap electrode
- These fittings are only available from your local Georg Fischer sales office

Multi/Saddle Plus Spatula for use with Iron Multi/Saddle Plus 201



Code	Description
709 613 904	Spatula for saddle outlet 1¼
709 613 905	Spatula for saddle outlet 1½ / d40 + d50

- These fittings are only available from your local Georg Fischer sales office

Multi/Saddle Straps for use with Iron Multi/Saddle Plus 201



Code	Strap Range	DN min	DN max	
709 613 930	2.375 in.	3.25 in.	60 mm	80 mm
709 613 932	2.75 in.	3.625 in.	70 mm	90 mm
709 613 934	3.625 in.	4.375 in.	90 mm	110 mm
709 613 936	4.375 in.	5.25 in.	110 mm	130 mm
709 613 938	5.25 in.	6.00 in.	130 mm	150 mm
709 613 940	5.75 in.	6.625 in.	145 mm	165 mm
709 613 942	6.375 in.	7.25 in.	160 mm	180 mm
709 613 944	7.00 in.	7.75 in.	175 mm	195 mm
709 613 946	7.625 in.	8.375 in.	190 mm	210 mm
709 613 948	8.25 in.	9.00 in.	205 mm	225 mm
709 613 950	8.75 in.	9.625 in.	220 mm	240 mm
709 613 952	9.375 in.	10.25 in.	235 mm	255 mm
709 613 954	10.00 in.	10.75 in.	250 mm	270 mm
709 613 956	10.75 in.	11.625 in.	270 mm	290 mm
709 613 958	11.375 in.	12.25 in.	285 mm	305 mm
709 613 960	12.00 in.	12.75 in.	300 mm	320 mm
709 613 962	12.625 in.	13.375 in.	315 mm	335 mm
709 613 964	13.375 in.	14.25 in.	335 mm	355 mm

- Ready to install, studs and nuts in one package
- These fittings are only available from your local Georg Fischer sales office

Electrofusion Fittings for PE pipes: Transition Saddles with Stainless Outlet



1¼" outlet

Part No.	Size	L	H	d	Sensor Type
10004673	2.0 in.	3.6	3.18	N/A	2552-1
10004686	3.0 in.	4.6	3.18	N/A	2552-1
10004700	4.0 in.	6.26	3.8	N/A	2552-1
10004717	6.0 in.	8.68	4.96	N/A	2552-1
10004740	8.0 in.	5.92	2.96	N/A	2552-1
Special request	10.0 in.	Call	Call	N/A	2552-1 or -2
Special request	12.0 in.	Call	Call	N/A	2552-1 or -2

- Transition saddle with 1¼ FNPT branch/outlet
- These fittings are only available from your local Georg Fischer sales office



1½" outlet

Part No.	Size	L	H	d	Sensor Type
10004676	2.0 in.	3.6	3.18	N/A	2552-3, 2540-XX, 3719-11
10004689	3.0 in.	4.6	3.18	N/A	2552-3, 2540-XX, 3719-11
10004703	4.0 in.	6.26	3.8	N/A	2552-3, 2540-XX, 3719-11
10004720	6.0 in.	8.68	4.96	N/A	2552-3, 2540-XX, 3719-11
10004743	8.0 in.	5.92	2.96	N/A	2552-3, 2540-XX, 3719-11
Special request	10.0 in.	Call	Call	N/A	2552-3, 2540-XX, 3719-11
Special request	12.0 in.	Call	Call	N/A	2552-3, 2540-XX, 3719-11

- Transition saddle with 1½ FNPT branch/outlet
- These fittings are only available from your local Georg Fischer sales office

Installation Fittings

ABS Installation Fittings



Code	DN	d	L	H	Z	D	Sensor Type
729 310 007	DN20	25	100	78	32	35	Flow -X0, pH -XX
729 310 008	DN25	32	110	81	33	44	Flow -X0, pH -XX
729 310 009	DN32	40	110	85	29	51	Flow -X0, pH- XX
729 310 010	DN40	50	120	89	29	63	Flow -X0, pH -XX
729 310 011	DN50	63	130	95	28	78	Flow -X0, pH -XX

- For use with P51530-X0, 3-2536-X0, 3-8510-X0, 3-8512-X0, 3-2537-XC-X0, 3-2551-X0-XX, 3-272X-XX
- Please contact your local Georg Fischer sales office for availability.

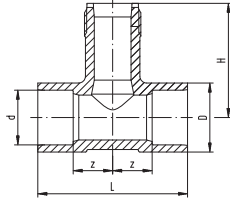

COOL-FIT® Installation Fittings

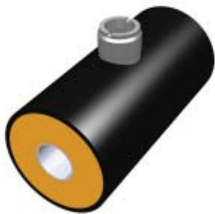

Code	DN	d	L	H	Z	D
738 310 107	DN20	25	220	78	110	90
738 310 108	DN25	32	220	81	110	90
738 310 109	DN32	40	220	85	110	110
738 310 110	DN40	50	220	89	110	110
738 310 111	DN50	63	220	95	110	125

- For use with only Georg Fischer COOL-FIT® systems and with Signet 6515 or 6536 Flow Sensors
- Please contact your local Georg Fischer sales office for availability.

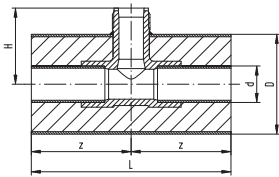

Installation Fittings (Plastic and Steel weld-on Fittings)

PVC Weld-on Fittings



Part No.	Code	DN	D	PN bar	Sensor Type	d x s mm
N/A	198 801 230	110.8 mm	39	6	Flow -X0, pH -XX	125 x 7.1
N/A	198 801 232	114.4 mm	39	10	Flow -X0, pH -XX	140 x 12.8
N/A	198 801 232	141.8 mm	39	6	Flow -X0, pH -XX	160 x 9.1
N/A	198 801 232	150 mm	39	3.2	Flow -X0, pH -XX	160 x 5.0
N/A	198 801 233	192 mm	39	4	Flow -X0, pH -XX	200 x 4.0
N/A	198 801 231	211 mm	39	3.2	Flow -X0, pH -XX	225 x 7.0
N/A	198 801 251	203 mm	39	10	Flow -X1	225 x 10.8
N/A	198 801 234	235.4 mm	39	6	Flow -X1	250 x 7.3
N/A	198 801 235	248.2 mm	39	6	Flow -X1	280 x 15.9
N/A	198 801 235	279.2 mm	39	6	Flow -X1	315 x 17.9

- For use with P51530-X0/-X1, 3-2536-X0/-X1, 3-8510-X0/-X1, 3-8512-X0/-X1, 3-2537-XC-X0/-X1, 3-2551-X0-XX/-X1-XX, 3-272X-XX
- Please contact your local Georg Fischer sales office for availability.

PP Weld-on Fittings

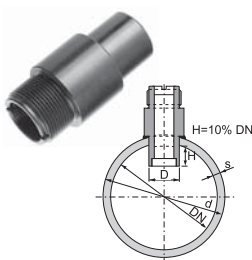

Part No.	Code	DN	D	PN bar	Sensor Type	d x s mm
N/A	198 801 254	61.2 mm	39	10	Flow -X0, pH -XX	75 x 6.9
N/A	198 801 254	79.8 mm	39	6	Flow -X0, pH -XX	90 x 5.1
N/A	198 801 257	102.2 mm	39	10	Flow -X0, pH -XX	125 x 11.4
N/A	198 801 257	124 mm	39	6	Flow -X0, pH -XX	140 x 8.0
N/A	198 801 257	131.2 mm	39	3.2	Flow -X0, pH -XX	140 x 4.4
N/A	198 801 256	159.6 mm	39	6	Flow -X0, pH -XX	180 x 10.2
N/A	198 801 248	199.4 mm	39	6	Flow -X0, pH -XX	225 x 12.8
N/A	198 801 253	248.2 mm	39	6	Flow -X1	280 x 15.9
N/A	198 801 253	290.6 mm	39	4	Flow -X1	315 x 12.2
N/A	198 801 252	315 mm	39	6	Flow -X1	355 x 120.0

- For use with P51530-X0/-X1, 3-2536-X0/-X1, 3-8510-X0/-X1, 3-8512-X0/-X1, 3-2537-XC-X0/-X1, 3-2551-X0-XX/-X1-XX, 3-272X-XX
- Please contact your local Georg Fischer sales office for availability.

SS Mounting Blocks (1.4401)

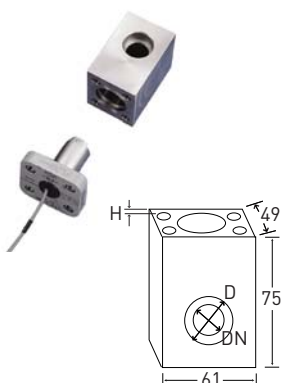

Part No.	Code	DN	Inch	D	H
525-2005	198 840 501	15	0.5	21.8	8.4
525-2007	198 840 502	20	0.75	27.2	12.7
525-2010	198 840 503	25	1.0	33.9	12.7

- For use with P525-1 and P525-1S
- Please contact your local Georg Fischer sales office for availability.

SS Weld-On Fittings (1.4401)

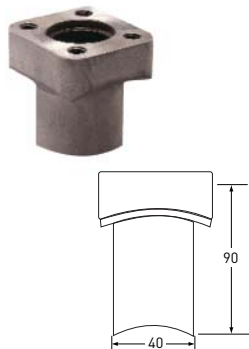

Part No.	Code	DN	Inch
N/A	198 150 346	40-800	1.5 - 30

- For use with P525-2 and P525-2S
- Please contact your local Georg Fischer sales office for availability.

Installation Fittings (Plastic and Steel weld-on Fittings)

PE Weld-on Fittings

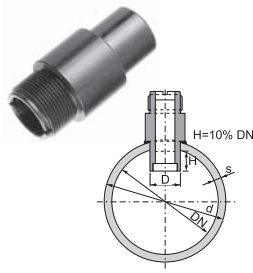

Part No.	Code	DN	D	PN bar	Sensor Type	d x s mm
N/A	198 801 249	61.2 mm	39	10	Flow -X0, pH -XX	75 x 6.9
N/A	198 801 249	79.8 mm	39	6	Flow -X0, pH -XX	90 x 5.1
N/A	198 801 236	97.4 mm	39	6	Flow -X0, pH -XX	110 x 6.3
N/A	198 801 237	102.2 mm	39	10	Flow -X0, pH -XX	125 x 11.4
N/A	198 801 236	110.8 mm	39	6	Flow -X0, pH -XX	125 x 7.1
N/A	198 801 237	131.2 mm	39	3.2	Flow -X0, pH -XX	140 x 4.4
N/A	198 801 238	114.4 mm	39	10	Flow -X0, pH -XX	140 x 12.8
N/A	198 801 237	124 mm	39	6	Flow -X0, pH -XX	140 x 8.0
N/A	198 801 239	130.8 mm	39	10	Flow -X0, pH -XX	160 x 14.6
N/A	198 801 238	141.8 mm	39	6	Flow -X0, pH -XX	160 x 9.1
N/A	198 801 240	147.2 mm	39	10	Flow -X0, pH -XX	180 x 16.4
N/A	198 801 238	150 mm	39	3.2	Flow -X0, pH -XX	160 x 5.0
N/A	198 801 239	159.6 mm	39	6	Flow -X0, pH -XX	180 x 10.2
N/A	198 801 241	163.6 mm	39	10	Flow -X0, pH -XX	200 x 18.2
N/A	198 801 240	177.2 mm	39	6	Flow -X0, pH -XX	200 x 11.4
N/A	198 801 239	187.6 mm	39	3.2	Flow -X0, pH -XX	200 x 6.2
N/A	198 801 241	199.4 mm	39	6	Flow -X0, pH -XX	225 x 12.8
N/A	198 801 242	184 mm	39	10	Flow -X1	225 x 20.5
N/A	198 801 242	221.6 mm	39	6	Flow -X1	250 x 14.2
N/A	198 801 243	248.2 mm	39	6	Flow -X1	280 x 15.9
N/A	198 801 244	279.2 mm	39	6	Flow -X1	315 x 17.9
N/A	198 801 243	290.6 mm	39	4	Flow -X1	315 x 12.2
N/A	198 801 245	314.8 mm	39	6	Flow -X1	355 x 20.1
N/A	198 801 246	354.6 mm	39	6	Flow -X1	400 x 22.7
N/A	198 801 245	369.2 mm	39	4	Flow -X1	400 x 15.4
N/A	198 801 247	399 mm	39	6	Flow -X1	450 x 25.5
N/A	198 801 250	443.4 mm	39	6	Flow -X2	500 x 28.3
N/A	198 801 255	581.4 mm	39	4	Flow -X2	630 x 24.3

- For use with P51530-X0/-X1/-X2, 3-2536-X0/-X1/-X2, 3-8510-X0/-X1, 3-8512-X0/-X1, 3-2537-XC-X0/-X1, 3-2551-X0-XX/-X1-XX/-X2-XX, 3-272X-XX
- Please contact your local Georg Fischer sales office for availability.

SS Weld-on Fittings (1.4435)

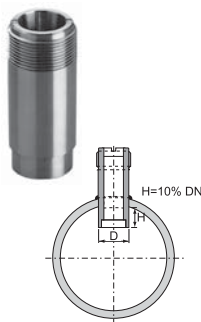

Part No.	Code	DN	D	PN bar	Sensor Type	d x s mm
N/A	198 801 268	≥50 mm	37	N/A	Flow -X0, pH -XX	N/A
N/A	198 801 269	≥300 mm	37	N/A	Flow -X1	N/A

- For use with P51530-X0/-X1, 3-2536-X0/-X1, 3-8510-X0/-X1, 3-8512-X0/-X1, 3-2537-XC-X0/-X1, 3-2551-X0-XX/-X1-XX, 3-272X-XX
- Please contact your local Georg Fischer sales office for availability.

Rev C (5/09)

© Georg Fischer Signet LLC

3401 Aerojet Avenue, El Monte, CA 91731-2882 U.S.A. • Tel. (626) 571-2770 • Fax (626) 573-2057 • www.gfsignet.com • e-mail: signet.ps@georgfischer.com
 Specifications subject to change without notice. All rights reserved. All corporate names and trademarks stated herein are the property of their respective companies.