

## MODEL 77C STAINLESS STEEL HEAVY DUTY FLEXIBLE COUPLING

The Model 77C is designed for high pressure applications including RO and desalination systems. The 77C is available in strong and anti corrosive alloys of 304, 316, 316L Stainless Steel, Duplex CD3MN (2205), Super Duplex CE8MN, CE3MN (2507). The 77C features 304 or 316 bolts and silicone bronze heavy nuts to help prevent galling during repetitive use.

### Sizes-Inches/DN

¾" to 12" (DN20 to DN300)

### Rated Working Pressure:

1200psi (83 bar) Sch40S, cut groove only



### Material Specifications

Housings:

- Super Duplex 2507(CE3MN) to ASTM A890 Grade 5A
- CE8MN to ASTM A890 Grade 2A
- Duplex 2205(CD3MN) to ASTM A890 Grade 4A
- Austenitic 254SMO (CK3MCuN) to A743
- Austenitic 904L (CN2MCuN) to A351
- Type 316 to ASTM A743 CF8M
- Type 316L to ASTM A743 CF3M

### Rubber Gaskets:

The gasket seal is C-shaped, made of standard gasket EPDM (ethylene propylene diene monomer) for cold water, hot water, rare acid, oil-free air and multiple chemical product (-50 – 150°C). It is not suitable for mediums like petroleum.

### Bolts:

Type 316 stainless steel track bolts ASTM A-193 B-8M

### Nuts:

Type 316 stainless steel nuts ASTM A-193 B-8MSilicone bronze heavy duty nuts to ASTM B98 C65100

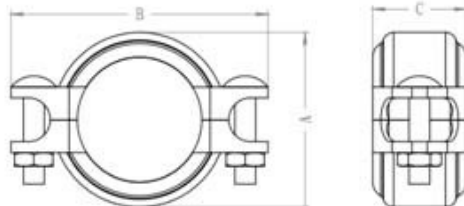

Nominal Size	Pipe OD	Rated Working Pressure	Pipe End Separation	Dimensions			
				A	B	C	Weight
mm / in	mm / in	psi / bar	mm / in	mm / in	mm / in	kgs / lbs	
20	26.900	1200	0-1.6	47.800	78.500	44.000	0.580
0.75	1.059	82.68	0-0.06	1.882	3.091	1.732	1.276
25	32.000	1200	0-1.6	55.000	87.500	44.000	0.600
	1.260	82.68	0-0.06	2.165	3.445	1.732	1.320
25	33.700	1200	0-1.6	55.000	87.500	44.000	0.660
1	1.327	82.68	0-0.06	2.165	3.445	1.732	1.452
32	38.000	1200	0-1.6	63.000	98.000	44.000	0.620
	1.496	82.68	0-0.06	2.480	3.858	1.732	1.364
32	42.400	1200	0-1.6	63.000	98.000	44.000	0.760
1.25	1.669	82.68	0-0.06	2.480	3.858	1.732	1.672
40	48.300	1200	0-1.6	72.000	102.000	44.000	0.661
1.5	1.900	82.68	0-0.06	2.835	4.016	1.732	1.455
50	57.000	1200	0-1.6	85.500	121.000	44.000	0.810
	2.244	82.68	0-0.06	3.365	4.764	1.732	1.782
50	60.300	1200	0-1.6	85.500	121.000	44.000	0.842
2	2.375	82.68	0-0.06	3.365	4.764	1.732	1.853
65	73.000	1200	0-1.6	98.000	136.600	45.000	0.989
2.5	2.875	82.68	0-0.06	3.858	5.378	1.772	2.176
65	76.100	1200	0-1.6	102.500	140.500	45.000	1.600
	3.000	82.68	0-0.06	4.035	5.531	1.772	3.520
80	88.900	1200	0-1.6	115.000	163.900	45.000	1.360
3	3.500	82.68	0-0.06	4.528	6.453	1.772	2.992
100	106.000	1200	0-3.2	137.900	189.900	52.000	3.350
	4.250	82.68	0-0.13	5.429	7.476	2.047	7.370
100	114.300	1200	0-3.2	150.000	206.300	52.000	2.700
4	4.500	82.68	0-0.13	5.908	8.122	2.047	5.940
125	133.000	1200	0-3.2	165.400	219.800	52.000	4.200
	5.250	82.68	0-0.13	6.512	8.654	2.047	9.240
125	139.700	1200	0-3.2	175.800	227.700	52.000	5.000
	5.500	82.68	0-0.13	6.921	8.965	2.047	11.000
125	141.300	1200	0-3.2	177.200	228.000	52.000	5.300
5	5.563	82.68	0-0.13	6.976	8.976	2.047	11.660
150	159.000	1200	0-3.2	197.000	259.800	52.000	6.800
	6.259	82.68	0-0.13	7.756	10.228	2.047	14.960
150	166.300	1200	0-3.2	204.500	272.600	52.000	7.500
6	6.625	82.68	0-0.13	8.051	10.732	2.047	16.500
200	219.100	1200	0-3.2	281.000	244.000	64.000	11.400
8	8.625	82.68	0-0.13	11.063	9.606	2.520	25.080
250	273.000	1200	0-3.2	342.000	400.000	65.000	16.000
10	10.750	82.68	0-0.13	13.485	15.748	2.559	35.200
300	323.900	1200	0-3.2	397.000	478.000	65.000	19.470
12	12.750	82.68	0-0.13	15.630	16.819	2.559	42.840